

Wave Cyber Residential Pressure Tank

6" to 13" Diameter, HDPE liner with FRP reinforced outer shell



Wave Cyber (Shanghai) Co., Ltd.

www.wave-cyber.com

Wave Cyber offers variety of pressure tanks from 6" to 13" diameter for residential or light commercial water filtration and softening applications.

Wave Cyber pressure tanks are made of high performance composite material – HDPE liner with FRP filament winding outer shell. Wave Cyber's design provides a continuous seamless inner liner shell with a GF PP inlet for higher strength, temperature and pressure capabilities.

Residential pressure tanks are available

- 6" to 13" diameter, 2.5"-8NPSM single top opening,
- 10" to 13" diameter, 4"-8UN single top and top/bottom openings
- 10" to 13" diameter, 2.5"-8NPSM single top opening with 1-1/4" x 1-1/2" Dome-hole opening

All residential pressure tanks are NSF, PED and KTW certified

Options

- Different colors are available.
- Opaque almond colored liner for out-doors application.



Wave Cyber (Shanghai) Co., Ltd.

www.wave-cyber.com



Specification

I. 2.5" 8-NPSM top, standard base

Tank Size	Volume		Weight (Kg)	Dimensions (mm)				
				Standard Base			Pole Piece	
	L	Cu. ft.		A	B	D	A	D
6 x 10	3.30	0.12	1.26	256	164	155	254	155
6 x 12	3.90	0.14	1.42	307	164	155	305	155
6 x 13	4.30	0.15	1.49	332	164	155	328	155
6 x 17	6.30	0.22	1.80	434	164	155	430	155
6 x 18	6.70	0.24	1.88	459	164	155	457	155
6 x 29	11.40	0.40	2.73	739	164	155	737	155
6 x 35	13.70	0.48	3.20	891	164	182	890	155
7 x 13	7.60	0.27	1.40	334	189	182	328	182
7 x 17	8.30	0.29	1.95	430	189	182	430	182
7 x 19	9.60	0.34	2.10	488	189	182	483	182
7 x 24	12.60	0.45	2.45	620	189	182	610	182
7 x 30	16.20	0.57	2.96	764	189	182	762	182
7 x 35	19.10	0.67	3.40	898	189	182	890	182
7 x 40	22.00	0.78	3.80	1018	189	182	1016	182
7 x 44	24.30	0.86	4.05	1129	189	182	1118	182
8 x 13	7.70	0.27	1.65	335	214	207	328	207
8 x 17	11.00	0.39	2.00	432	214	207	430	207
8 x 18	12.50	0.44	2.18	459	214	207	457	207
8 x 24	16.60	0.59	2.88	612	214	207	610	207
8 x 30	21.40	0.76	3.61	762	214	207	762	207
8 x 35	24.80	0.88	4.15	898	214	207	890	207
8 x 40	29.10	1.03	4.53	1018	214	207	1016	207
8 x 44	32.10	1.13	4.80	1132	214	207	1118	207
8 x 47	34.80	1.23	5.17	1196	214	207	N/A	N/A
9 x 17	13.70	0.48	2.25	431	240	233	430	233
9 x 18	14.70	0.57	2.42	459	240	233	457	233
9 x 24	20.40	0.79	3.06	610	240	233	605	233
9 x 30	26.60	0.94	3.68	772	240	233	762	233
9 x 35	31.60	1.12	4.20	896	240	233	890	233
9 x 40	36.30	1.28	4.84	1018	240	233	1016	233
9 x 42	38.20	1.35	5.05	1074	240	233	1067	233
9 x 48	44.00	1.58	6.05	1228	240	233	1219	233
10 x 13	12.20	0.44	2.62	345	264	258	340	258
10 x 16	15.60	0.55	2.91	410	264	258	406	258
10 x 17	16.00	0.59	3.00	436	264	258	430	258
10 x 18	18.00	0.64	3.17	461	264	258	457	258
10 x 19	19.20	0.68	3.30	487	264	258	483	258
10 x 22	22.90	0.81	3.66	559	264	258	559	258
10 x 24	25.10	0.89	3.89	605	264	258	605	258
10 x 30	32.40	1.14	4.49	762	264	258	762	258
10 x 35	38.40	1.36	4.60	897	264	258	8902	258
10 x 40	44.90	1.59	5.86	1020	264	258	1016	258
10 x 44	50.10	1.77	6.55	1126	264	258	1118	258
10 x 47	55.00	1.90	6.95	1190	264	258	1194	258
10 x 54	62.40	2.20	7.90	1386	264	258	1372	258
12 x 48	79.50	2.89	8.40	1232	311	310	N/A	N/A
12 x 52	87.30	3.08	8.95	1338	311	310	N/A	N/A
13 x 44	84.80	3.00	8.40	1140	338	336	N/A	N/A
13 x 54	105.70	3.73	10.80	1398	338	336	N/A	N/A



Wave Cyber (Shanghai) Co., Ltd.

www.wave-cyber.com

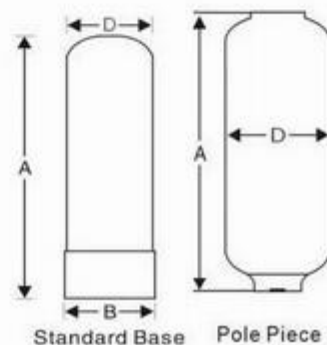

II. 4"Top opening with standard base and double opening with extended base

Size	Opening	Volume		Weight (kg)	Dimension (mm)			
		L	Cu.ft		A	B	C	D
10 x 54	4"	62.40	2.20	7.90	1386	264	a	258
12 x 48	4"	79.50	2.89	8.49	1227	310.5	a	258
	2.5" -2.5"			a	a		a	
	2.5" - 4"			a	a		a	
12 x 52	4"	87.30	3.08	9.04	1333	310.5	a	310
	2.5" -2.5"			a	a		a	
	2.5" - 4"			a	a		a	
13 x 44	4"	84.80	3.00	8.40	1140	338	a	336
	2.5" -2.5"			a	a		a	
	2.5" - 4"			a	a		a	
13 x 54	4"	105.70	3.73	10.80	1398	338	a	336
	2.5" -2.5"			a	a		a	
	2.5" - 4"			a	a		a	

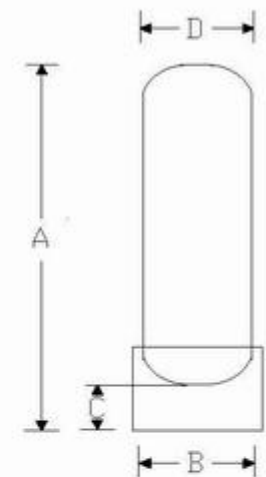

II. 4" Top and double opening

- a - to be confirmed

III. Dome Hole tank - 2.5" NPSM top, 1-1/4"-11.5 NPSM Dome-hole opening, standard base

Size	Volume		Weight (kg)	Dimension (mm)			
	L	Cu.ft		A	B	C	D
10 x 47	54.00	1.90	8.95	1200	264	N/A	258
10 x 54	62.40	2.20	9.65	1386	264	N/A	258
12 x 48	79.50	2.89	12.10	1232	311	N/A	310
12 x 52	87.30	3.08	12.75	1338	311	N/A	310
13 x 44	84.80	3.00	11.80	1145	338	N/A	338
13 x 54	105.70	3.73	13.85	1400	338	N/A	338

Operating Conditions:-

Operating pressure: 150 psi (10.5 bars);

Operating Temp: 120°F (49°C)



Wave Cyber (Shanghai) Co., Ltd.

005- WCRT-en-C